

# OWNER'S MANUAL

Electric Fan  
Model: MS1618W

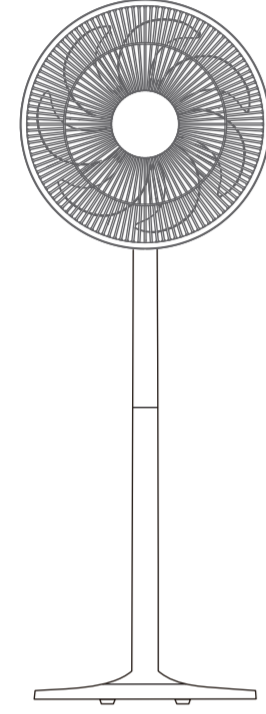

## READ AND SAVE THESE INSTRUCTIONS

Attention: Pictures in the IM are for reference only.

### CAUTION

Read Rules for Safe Operation and Instructions Carefully.

### WARNING

- If the supply cord is damaged, it must be replaced by manufacturer, its service agent or a similarly qualified person in order to avoid a hazard.
- This appliance can be used by children aged from 8 years and above and persons with reduced physical, sensory or mental capabilities or lack of experience and knowledge if they have been given supervision or instruction concerning use of the appliance in a safe way and understand the hazards involved. Children shall not play with the appliance. Cleaning and user maintenance shall not be made by children without supervision.
- Correct Disposal of this product  
This marking indicates that this product should not be disposed with other household wastes throughout the EU. To prevent possible harm to the environment or human health from uncontrolled waste disposal, recycle it responsibly to promote the sustainable reuse of material resources. To return your used device, please use the return and collection systems or contact the retailer where the product was purchased. They can take this product for environmental safe recycling. The packaging material is recyclable. Dispose of the packaging in an environmentally friendly manner and make it available for the recyclable material collection-service.
- Indoor and household use only.
- When the appliance is not in use and before cleaning, unplug the appliance from the outlet.
- To protect against the risk of electrical shock, do not disassemble the fan and do not immerse the unit, cord or plug in water or other liquid.

1

## INSTALLATION INSTRUCTIONS

### Name of components

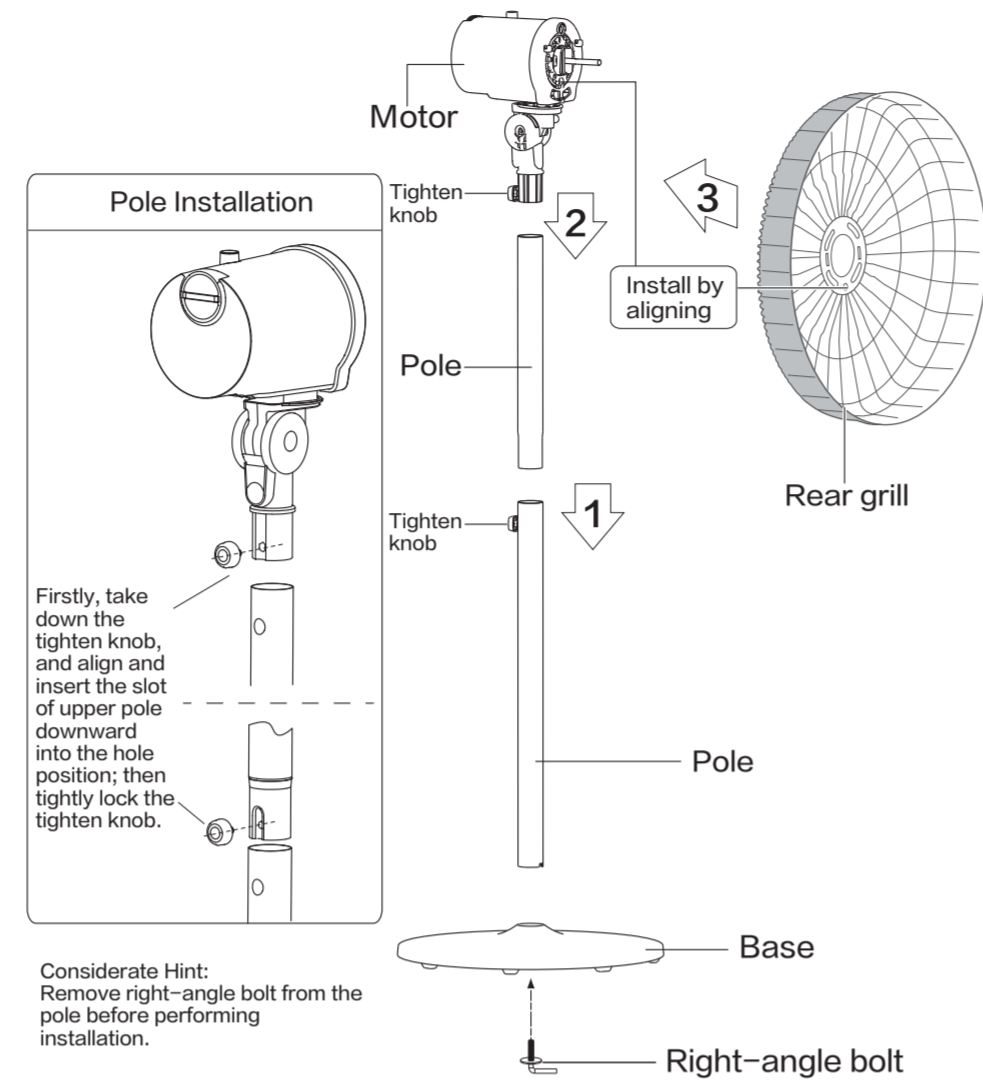

2

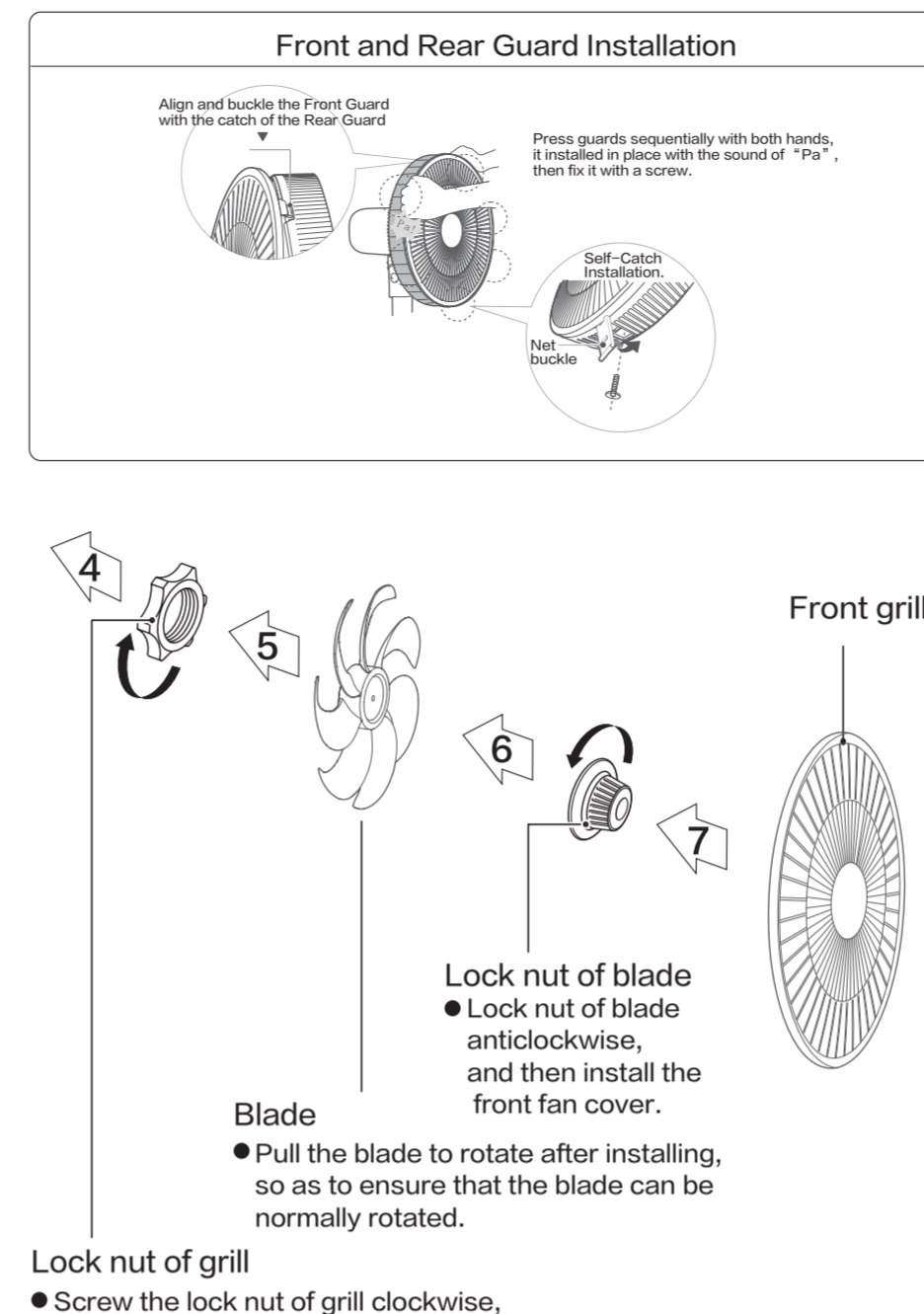

3

## INSTRUCTIONS FOR USE

### Instructions for operation of body

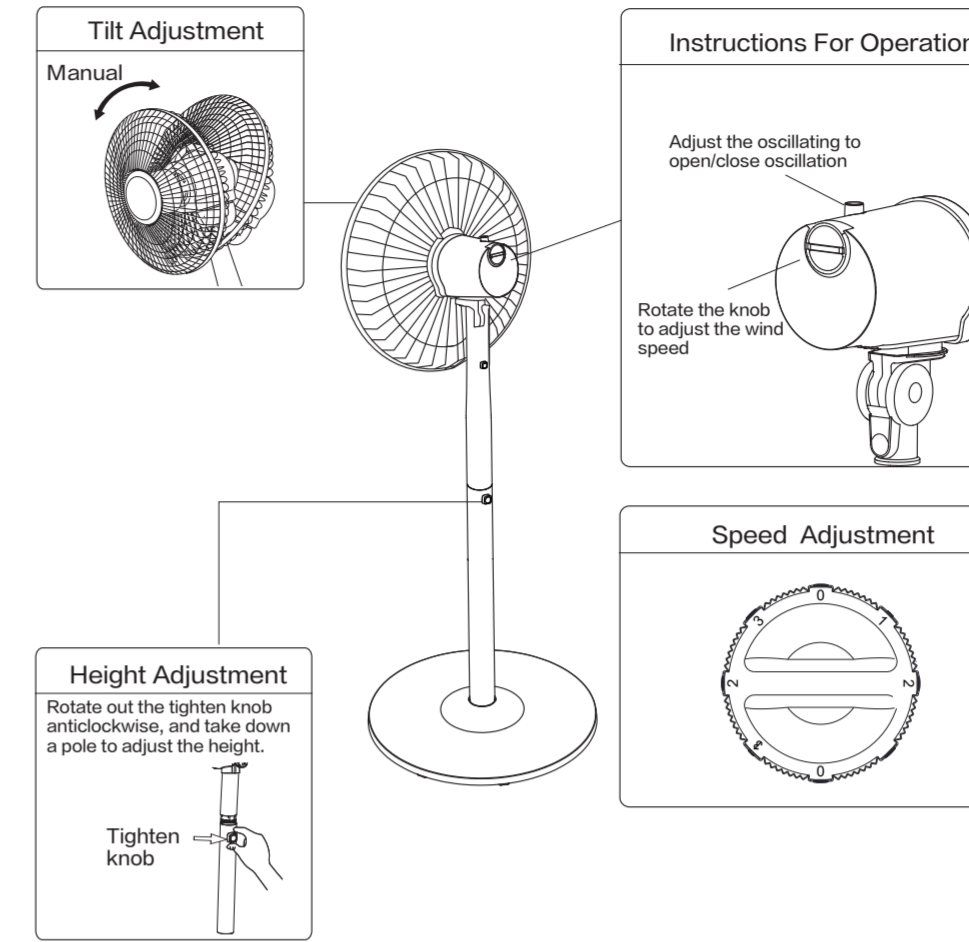

4

## MAINTENANCE INSTRUCTION

- The fan requires little maintenance. Do not try to fix it by yourself. Refer it to qualified service personnel if service is needed.
- Before cleaning and assembling, fan must be unplugged.
  - To ensure adequate air circulation to the motor, keep vents at the rear of the motor free of dust. Do not disassemble the fan to remove dust.
  - Please wipe the exterior parts with a soft cloth soaking a mild detergent.
  - Do not use any abrasive detergent or solvents to avoid scratching the surface.  
Do not use any of the following as a cleaner: gasoline, thinner.
  - Do not allow water or any other liquid into the motor housing or interior parts.

### CLEANING

- Be sure to unplug from the electrical supply source before cleaning.
- Plastic parts should be cleaned with a soft cloth moisten with mild soap. Thoroughly remove soap film with dry cloth.

5

# 说明书

落地扇  
MS1618W

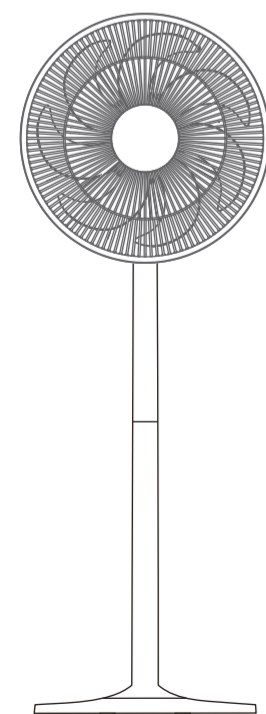

此图纸不作印刷，仅用于产品使用说明。说明书中图片仅为示意图，若有变动，请以实物为准！

## 警语中文省略

### 安装说明

#### 各部件名称 请按顺序安装

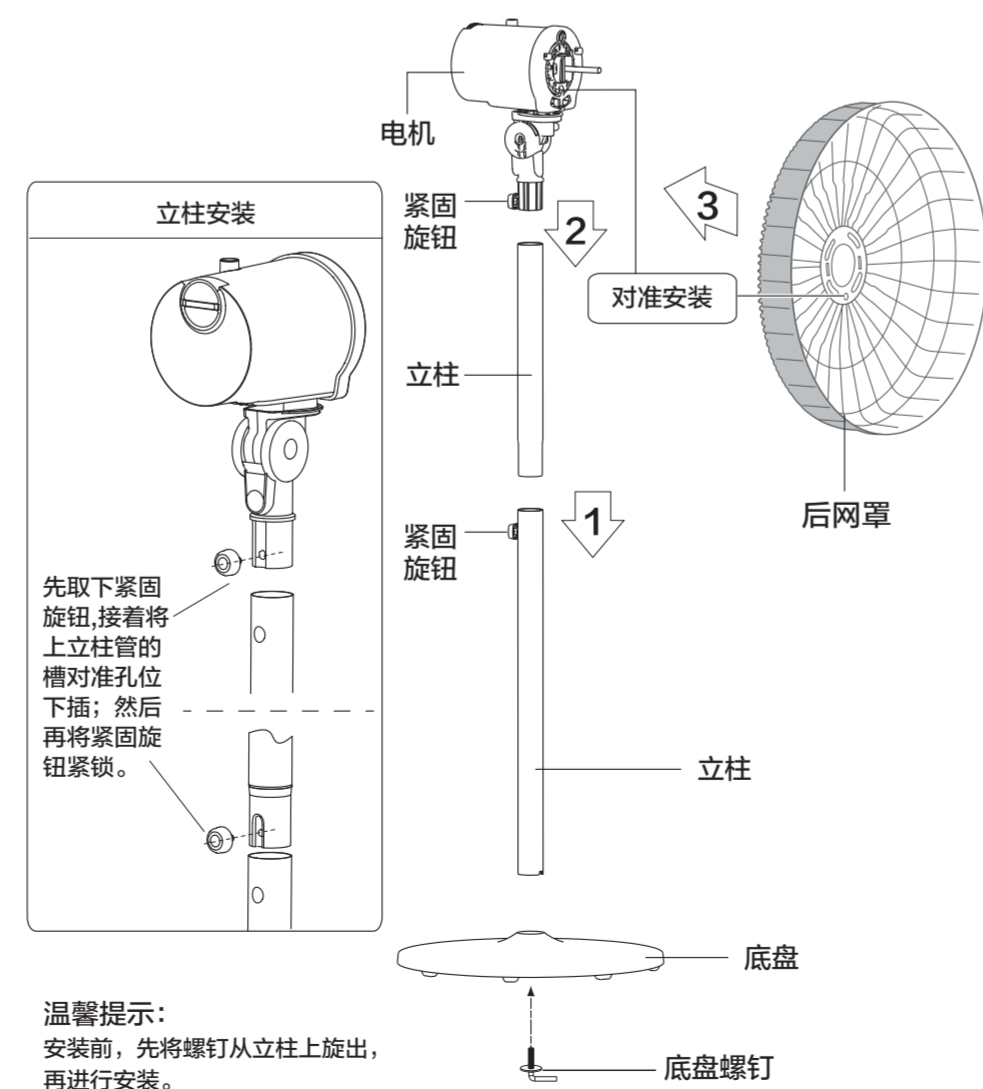

1

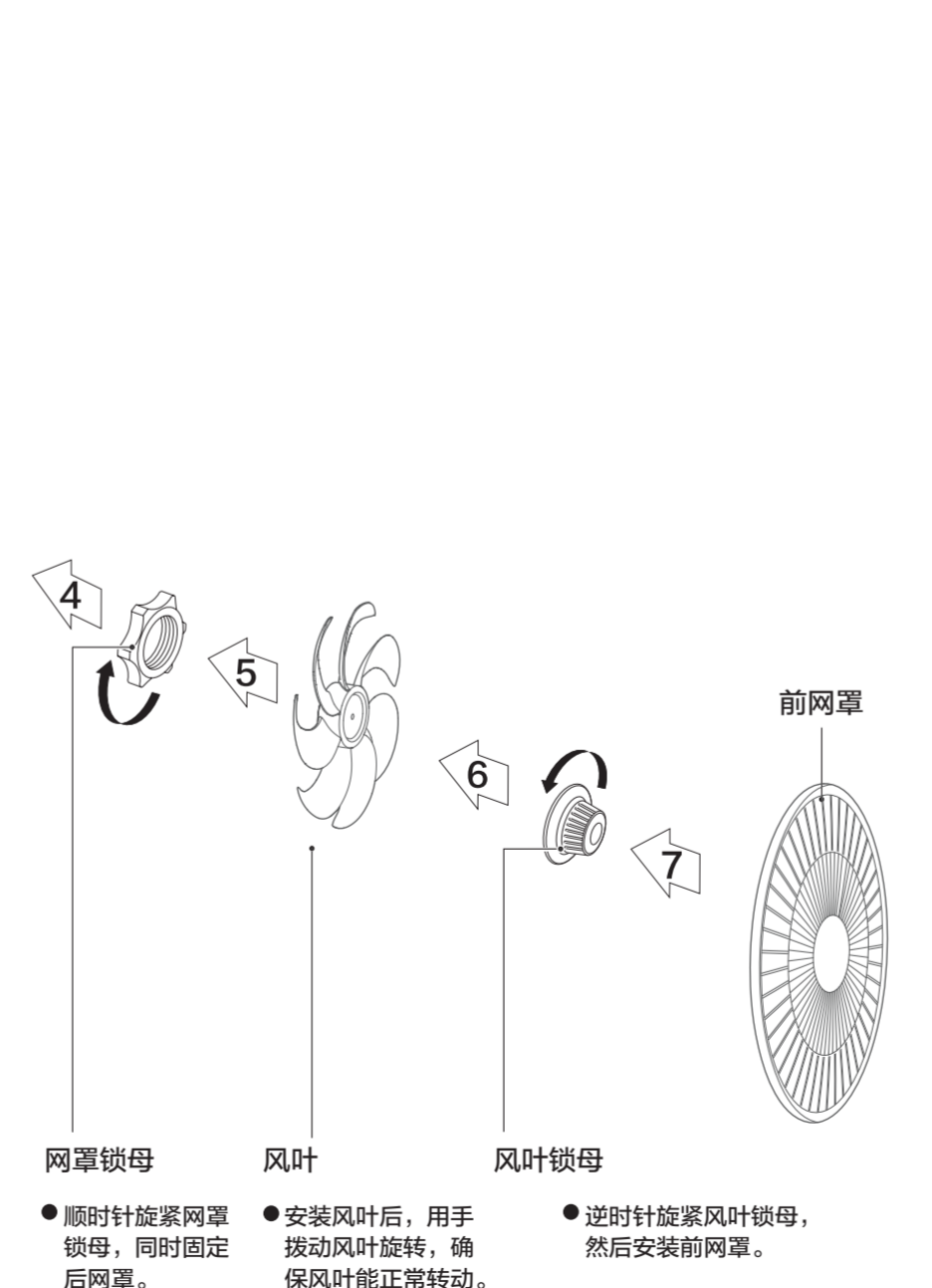

2

### 使用说明

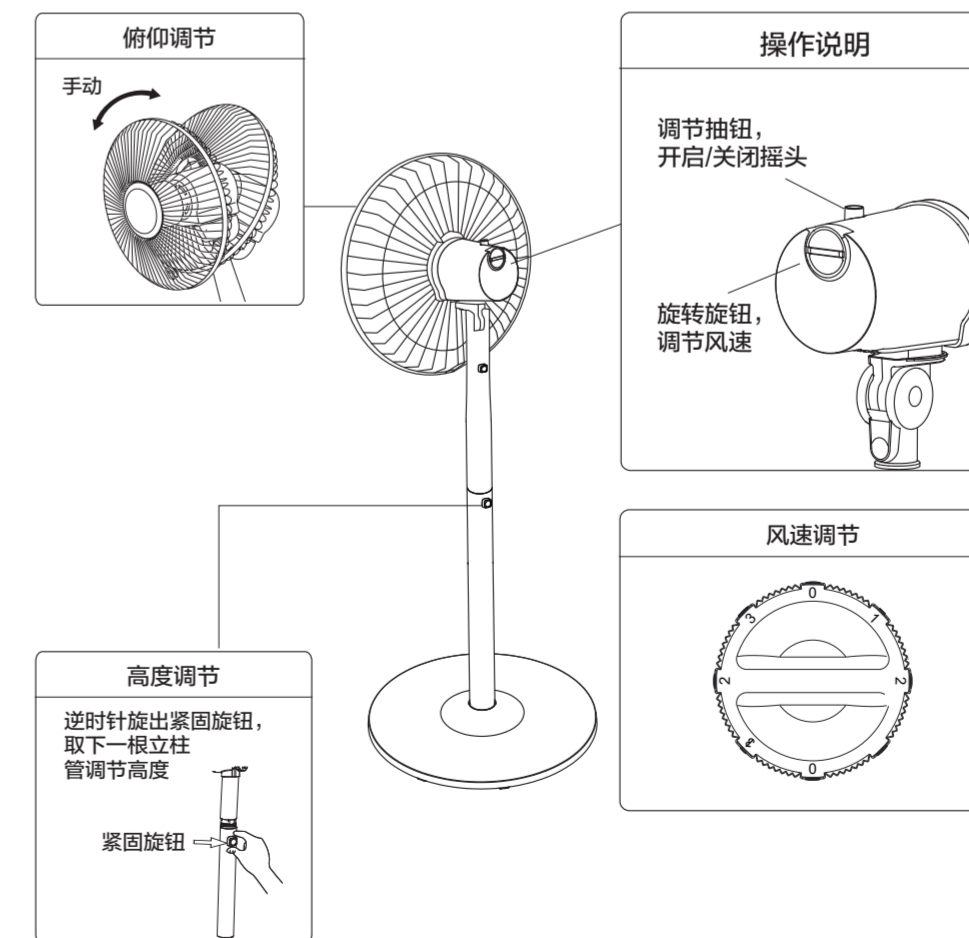

3